

TAG THAT *trend*

L.O.V.E



*Jeong Hwa
Yeong*



WHAT YOU NEED
File, Miss Blossom Super Base Gel, Miss Blossom Overlay Top Gel, Miss Blossom Super Volume Gel, Miss Blossom Syrup White Gel (SB-21), Miss Blossom Illust Gel (01, 22, 39, 83), Miss Blossom Gel Brush (03, 05, 07), Miss Blossom Gel Cleaner, Gel Palette, Pearl Stones, Sponge, Tweezers, LED Lamp.

GETTING PREPARED
Prepare your table in an organized manner eliminating cross contamination from the products. Make sure all necessary products are within hand's reach, so the colors are ready to use on the nail desk.

With over seven years of experience in the beauty industry, Jeong is the proud founder of Sosohan Nail Salon, a renowned establishment known for its high-quality nail care and exceptional service. As an accomplished business owner, she has built her salon from the ground up, focusing on creating a welcoming and professional environment for clients to enjoy.

In addition to her role as a business owner, Jeong is also a dedicated educator.

Through her hard work and dedication, Jeong continues to make a significant impact, both as a salon owner and as an educator, helping shape the next generation of nail technicians.



1 Prepare the nail or tip.



2 Apply base gel & cure.



3 Apply a soft white gel polish & cure.



4 Repeat step 3 & cure.



5 Apply a white shimmer gel & cure.

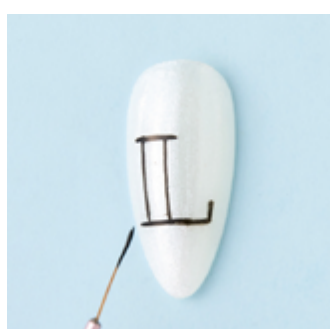

6 Use a fine liner brush with black gel paint to outline the letter "L".



Jeong Hwa Yeong

South Korea

IG: @sosohan_nail



7 Add a pink gel paint oval highlight over the letter & cure.



8 Perfect & fill in the letter with black gel paint & cure. Then add gel top coat & cure again.

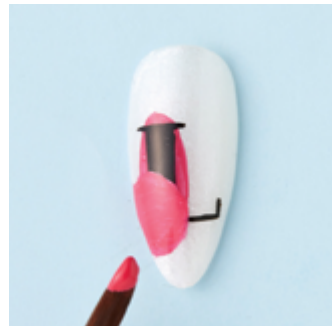

9 Swirl pink & white gel paint together in a circle to create the base of a rose.

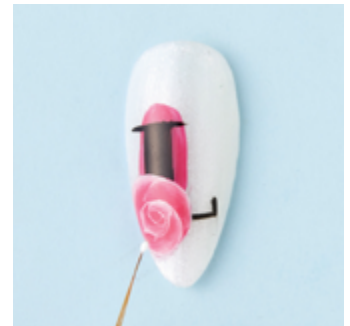

10 Use a detailed liner brush with white gel paint to create the details in the rose. When complete, cure.

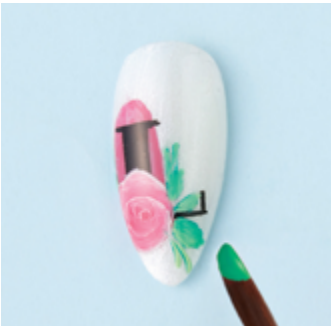

11 Design leaves with a small angle brush & green gel paint.



12 Add details to the leaves with white gel paint, then cure.



13 Finish with gel top coat & cure.